

Angle-Line Strainers



Sani-Matic Angle-Line Strainers allow operators to clean the strainer element without removing the strainer body from the process line, which significantly increases production uptime.

Sani-Matic offers several Angle-Line Strainer configurations, including the standard 4" Body Size Angle-Line Strainers, High-Capacity Angle-Line Strainers (6" Body Size) for higher volume process straining, Magnetic Trap Strainers for ferromagnetic capture, and strainers with sight-glass and sample / drain ports.

Our Angle-Line Strainers provide the option between an end-inlet or side-inlet flow direction by simply changing a few internal parts.

Multi-Angle-Line Strainer Assemblies can be used to reduce downtime by allowing one or more strainers to be valved open and operational, while the other strainer(s) are closed for cleaning and/or maintenance. They can also be configured as parallel components and used simultaneously, which provides the ability to split a process flow rate between two or more strainers.



Angle-Line Strainers are authorized to carry a 3-A symbol when using perforated elements.



QUICK TIPS Did you know strainer clips and elastomers are consumable items and fatigue over time?

Clips: The fit of a clip must be checked regularly and replaced when it no longer provides a secure fit or is overly worn.

Elastomers: Plan to replace the strainer elastomers annually at a minimum.

Not sure when to clean a strainer? Installing a pressure gauge before and after a strainer can help. When the gauge placed after the strainer drops 8 to 10 psi following the initial flow start-up, you'll know it is time to clean.

GOOD TO KNOW

- **Strainer & Element Material:** 316Lss
- **Sanitary ID Finish:** 32 μ in Ra
- **CRN Registered Maximum Pressure Rating (Standard Tri-Clamp):** 100 psi (4" body)
- **Full Assembly Maximum Pressure Rating (Standard Tri-Clamp):** 125 psi (4" body), 75 psi (6" body)
- **Full Assembly Maximum Pressure Rating (High Pressure Tri-Clamp):** 200 psi (4" & 6" body)
- **Maximum Temperature Rating:** 250 °F
- Wedgewire elements have some interior surfaces greater than 32 μ in Ra due to the construction process.
- For wedgewire element sizing, it is recommended that the slot size is 30-50% smaller than the particle size to increase capture efficiency (e.g., to capture a 0.010" particle, use 0.005" or 0.007" wedgewire).
- A hot water jacket option is available for 4" strainer bodies, contact Sani-Matic for custom quoting.
- When shipped, strainer assemblies with a Teflon Encapsulated O-ring are not lubricated. Strainer assemblies with other O-ring materials will be lubricated with an FDA-compliant silicone grease.
- High-Capacity Angle-Line Strainers have a 6" Body Size and are ideal for higher-volume processes.
- Sample / Drain Ports are 0.5" tri-clamp ports added to the frame tri-clamp cap (for magnetic trap strainers, they are added to the strainer body). They drain a majority of the liquid, but are not 100% drainable. *NOTE: A cap or sample valve is not included in the assembly.*
- End-Inlet Strainers are Standard Flow and Side-Inlet Strainers are Reverse Flow.
- Filter tubes are FDA-compliant, and when used with perforated elements $\frac{3}{32}$ " or larger maintain overall strainer assembly 3-A authorization.
- Tuf-Flex® Gaskets are PTFE gaskets with an EPDM core that helps to reduce "stickiness" of the gasket allowing for an easier and quicker strainer element removal process.

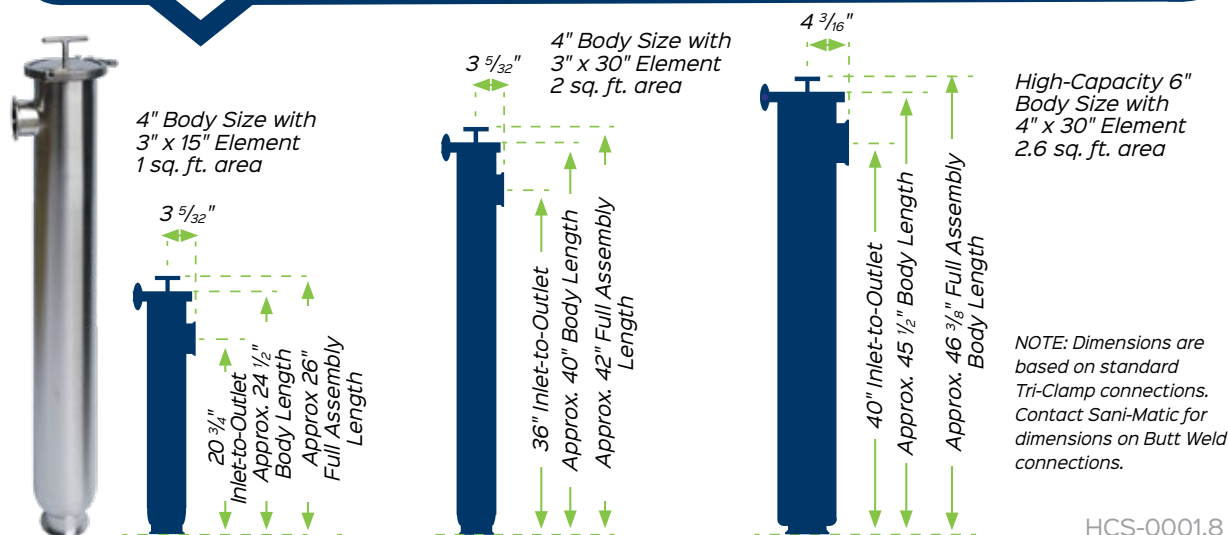

Angle-Line Strainer Model Number Key

Example Model #: AS15T3-P125S54000

		1	2	3	4	5	6	7	8	9	10	11	12	13	14	15	16
1	Strainer Model																
	A	Angle-Line															
2	Body Length																
	S	SHORT Body															
	L	LONG Body															
3, 4	Connection Size																
	15	1.5"															
	20	2.0"															
	25	2.5"															
	30	3.0"															
	40	4.0"															
5	Connection Type																
	T	Tri-Clamp (Standard)															
	H	Tri-Clamp - High Pressure Clamp															
	W	Butt Weld*															
6	Finish / Polish																
	3	32 µin Ra / Mechanical Polish (Standard)															
	1	20 µin Ra / Mechanical Polish*															
	8	32 µin Ra / Electropolish*															
	4	15 µin Ra / Electropolish*															
7-10	Element Type / Size																
	P062	Perforated / 0.0625" (1/16")															
	P093	Perforated / 0.09375" (3/32")															
	P125	Perforated / 0.125" (1/8")															
	P250	Perforated / 0.25" (1/4")															
	P375	Perforated / 0.375" (3/8")															
	W001	Wedgewire / 0.001"															
	W002	Wedgewire / 0.002"															
	W005	Wedgewire / 0.005"															
	W007	Wedgewire / 0.007"															
	W010	Wedgewire / 0.010"															
	W015	Wedgewire / 0.015"															
	W020	Wedgewire / 0.020"															
	W030	Wedgewire / 0.030"															
	W040	Wedgewire / 0.040"															
	W060	Wedgewire / 0.060"															
	W187	Wedgewire / 0.1875"															
11	Flow Direction																
	S	End-Inlet (Standard Flow)															
	R	Side-Inlet (Reverse Flow)															
12	Seal Kit																
	5	EPDM Gasket / Teflon Encapsulated Silicone O-Ring (Standard)															
	6	Viton Gasket / Teflon Encapsulated Silicone O-Ring															
	8	Buna-N Gasket / Teflon Encapsulated Silicone O-Ring															
	9	Silicone Gasket / Teflon Encapsulated Silicone O-Ring															
	T	Tuf-Flex Gasket / Teflon Encapsulated Silicone O-Ring															
	0	EPDM Gasket / EPDM O-Ring															
	1	Viton Gasket / Viton O-Ring															
	3	Buna-N Gasket / Buna-N O-Ring															
13, 14	Body Size																
	40	4.0"															
15	Option #1																
	0	None (Standard)															
	M	Magnetic Trap**															
16	Option #2																
	0	None (Standard)															
	2	Dual Sight Glass*															
	D	Drain / Sample Port*															
	3	Dual Sight Glass & Drain / Sample Port*															

***Non-stock product option. Longer lead times apply. Non-returnable.**

NOTE: See page 34 for element details.

**Magnetic Trap option only available with End-Inlet (Standard Flow) strainers and for 1.5" - 3.0" connection sizes.

Reference: Former Part Number & New Model Number Comparison

Reference Model Number Key for selections to be made. Selections are designated by empty **green** boxes in the tables below.



Angle-Line End-Inlet (Standard Flow)

Connection Size	Body Size	Max. gpm	SHORT (20 3/4" Inlet-to-Outlet)		LONG (36" Inlet-to-Outlet)	
			Perforated Old Part #	Perforated New Model Key #	Perforated Old Part #	Perforated New Model Key #
1.5"	4"	55	S10026	AS15T3-P <input type="text"/> S <input type="text"/> 40 <input type="text"/>	S10036	AL15T3-P <input type="text"/> S <input type="text"/> 40 <input type="text"/>
2.0"	4"	105	S10027	AS20T3-P <input type="text"/> S <input type="text"/> 40 <input type="text"/>	S10037	AL20T3-P <input type="text"/> S <input type="text"/> 40 <input type="text"/>
2.5"	4"	165	S10028	AS25T3-P <input type="text"/> S <input type="text"/> 40 <input type="text"/>	S10038	AL25T3-P <input type="text"/> S <input type="text"/> 40 <input type="text"/>
3.0"	4"	245	S10029	AS30T3-P <input type="text"/> S <input type="text"/> 40 <input type="text"/>	S10039	AL30T3-P <input type="text"/> S <input type="text"/> 40 <input type="text"/>
4.0"	4"	330	S10030	AS40T3-P <input type="text"/> S <input type="text"/> 400 <input type="text"/>	S10040	AL40T3-P <input type="text"/> S <input type="text"/> 40 <input type="text"/>
Connection Size	Body Size	Max. gpm	Wedgewire Old Part #	Wedgewire New Model Key #	Wedgewire Old Part #	Wedgewire New Model Key #
1.5"	4"	55	S10146	AS15T3-W <input type="text"/> S <input type="text"/> 40 <input type="text"/>	S10156	AL15T3-W <input type="text"/> S <input type="text"/> 40 <input type="text"/>
2.0"	4"	105	S10147	AS20T3-W <input type="text"/> S <input type="text"/> 40 <input type="text"/>	S10157	AL20T3-W <input type="text"/> S <input type="text"/> 40 <input type="text"/>
2.5"	4"	165	S10148	AS25T3-W <input type="text"/> S <input type="text"/> 40 <input type="text"/>	S10158	AL25T3-W <input type="text"/> S <input type="text"/> 40 <input type="text"/>
3.0"	4"	245	S10149	AS30T3-W <input type="text"/> S <input type="text"/> 40 <input type="text"/>	S10159	AL30T3-W <input type="text"/> S <input type="text"/> 40 <input type="text"/>
4.0"	4"	330	S10150	AS40T3-W <input type="text"/> S <input type="text"/> 400 <input type="text"/>	S10160	AL40T3-W <input type="text"/> S <input type="text"/> 40 <input type="text"/>

NOTE: Magnetic Trap option is not available with 4.0" Connection Size.

NOTE: If using filter tubes, the maximum recommended flow rate (gpm) may decrease depending on process conditions.



Angle-Line Side-Inlet (Reverse Flow)

Connection Size	Body Size	Max. gpm	SHORT (20 3/4" Inlet-to-Outlet)		LONG (36" Inlet-to-Outlet)	
			Perforated Old Part #	Perforated New Model Key #	Perforated Old Part #	Perforated New Model Key #
1.5"	4"	55	X10026	AS15T3-P <input type="text"/> R <input type="text"/> 400 <input type="text"/>	X10036	AL15T3-P <input type="text"/> R <input type="text"/> 400 <input type="text"/>
2.0"	4"	105	X10027	AS20T3-P <input type="text"/> R <input type="text"/> 400 <input type="text"/>	X10037	AL20T3-P <input type="text"/> R <input type="text"/> 400 <input type="text"/>
2.5"	4"	165	X10028	AS25T3-P <input type="text"/> R <input type="text"/> 400 <input type="text"/>	X10038	AL25T3-P <input type="text"/> R <input type="text"/> 400 <input type="text"/>
3.0"	4"	245	X10029	AS30T3-P <input type="text"/> R <input type="text"/> 400 <input type="text"/>	X10039	AL30T3-P <input type="text"/> R <input type="text"/> 400 <input type="text"/>
4.0"	4"	430	X10030	AS40T3-P <input type="text"/> R <input type="text"/> 400 <input type="text"/>	X10040	AL40T3-P <input type="text"/> R <input type="text"/> 400 <input type="text"/>
Connection Size	Body Size	Max. gpm	Wedgewire Old Part #	Wedgewire New Model Key #	Wedgewire Old Part #	Wedgewire New Model Key #
1.5"	4"	55	X10146	AS15T3-W <input type="text"/> R <input type="text"/> 400 <input type="text"/>	X10156	AL15T3-W <input type="text"/> R <input type="text"/> 400 <input type="text"/>
2.0"	4"	105	X10147	AS20T3-W <input type="text"/> R <input type="text"/> 400 <input type="text"/>	X10157	AL20T3-W <input type="text"/> R <input type="text"/> 400 <input type="text"/>
2.5"	4"	165	X10148	AS25T3-W <input type="text"/> R <input type="text"/> 400 <input type="text"/>	X10158	AL25T3-W <input type="text"/> R <input type="text"/> 400 <input type="text"/>
3.0"	4"	245	X10149	AS30T3-W <input type="text"/> R <input type="text"/> 400 <input type="text"/>	X10159	AL30T3-W <input type="text"/> R <input type="text"/> 400 <input type="text"/>
4.0"	4"	430	X10150	AS40T3-W <input type="text"/> R <input type="text"/> 400 <input type="text"/>	X10160	AL40T3-W <input type="text"/> R <input type="text"/> 400 <input type="text"/>

NOTE: Magnetic Trap option is not available with Reverse Flow.

NOTE: If using filter tubes, the maximum recommended flow rate (gpm) may decrease depending on process conditions.

Angle-Line Strainer Options

The Drain / Sample Port helps operators drain strainers before removing the element for cleaning. Air relief sample valves are recommended for the Drain / Sample Port option.

Strainer sight glasses provide visual access to particulate buildup levels.

See Magnetic Trap Strainer section for more details on that option.

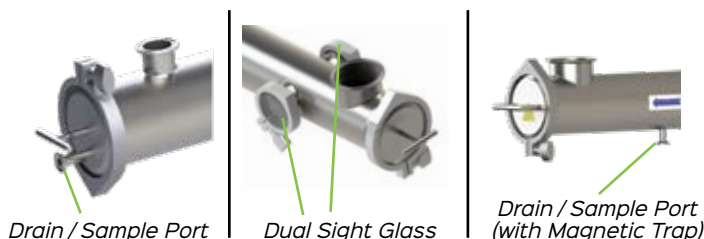

Cv Values & Pressure Drops for Angle-Line Strainers

Cv values or the provided pressure drop tables can be used to estimate the pressure drop across a strainer at a given flow rate. Cv values are for water at 70 °F. Contact Sani-Matic for inquiries on pressure drops for fluids with other viscosities.

Cv Values

Body Size	Body Length	Flow Configuration	Connection Size	Cv
4.0"	LONG (36")	End-Inlet (Standard Flow)	1.5"	38
			2.0"	72
			2.5"	95
			3.0"	97
			4.0"	102
	SHORT (20 ¾")		1.5"	36
			2.0"	82
			2.5"	100
			3.0"	102
			4.0"	106
	LONG (36")	Side-Inlet (Reverse Flow)	1.5"	36
			2.0"	77
			2.5"	112
			3.0"	125
			4.0"	155
	SHORT (20 ¾")		1.5"	39
			2.0"	77
			2.5"	120
			3.0"	142
			4.0"	160
6.0"	LONG (36")	End-Inlet (Standard Flow)	3.0"	196
			4.0"	214
			6.0"	250
		Side-Inlet (Reverse Flow)	3.0"	186
			4.0"	233
			6.0"	266

NOTE: Cv values and charted pressure drops can be used for perforated, wedgewire, and perforated with mesh overlays or filter tubes. The clean pressure drop is minimally impacted by the element configuration in most cases. For worst-case calculations, add 20% to the calculated pressure drop.

Angle-Line Strainer Pressure Drop: 4.0" Body, End-Inlet (Standard Flow), LONG Body (36")

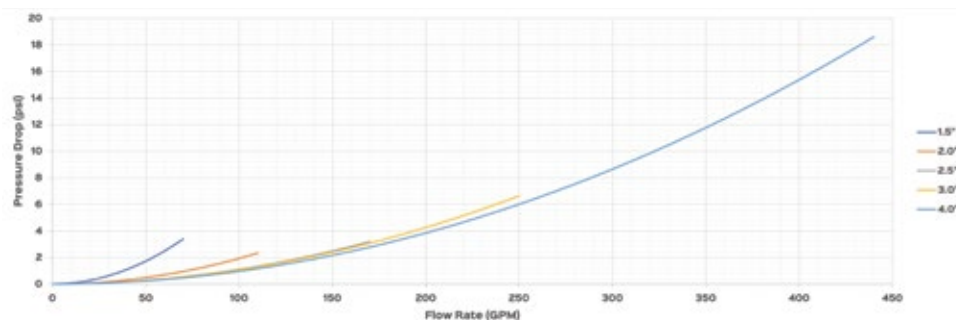

Angle-Line Strainer Pressure Drop: 4.0" Body, End-Inlet (Standard Flow), SHORT Body (20 3/4")

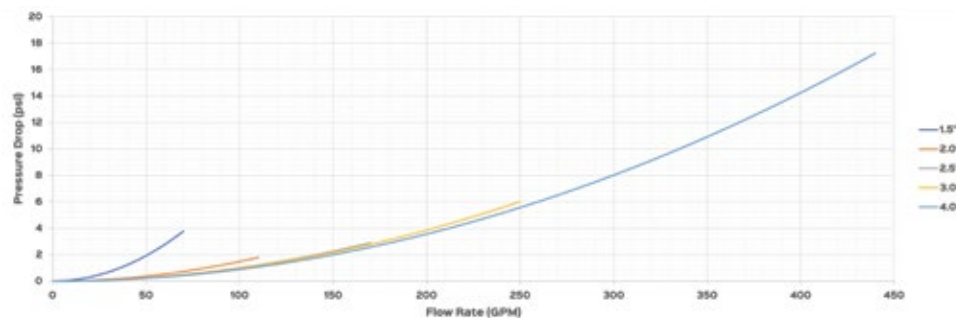

Angle-Line Strainer Pressure Drop: 4.0" Body, Side-Inlet (Reverse Flow), LONG Body (36")

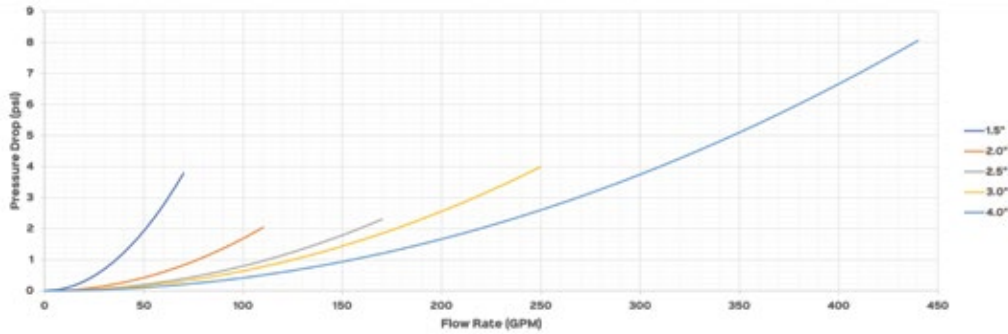

Angle-Line Strainer Pressure Drop: 4.0" Body, Side-Inlet (Reverse Flow), SHORT Body (20 3/4")

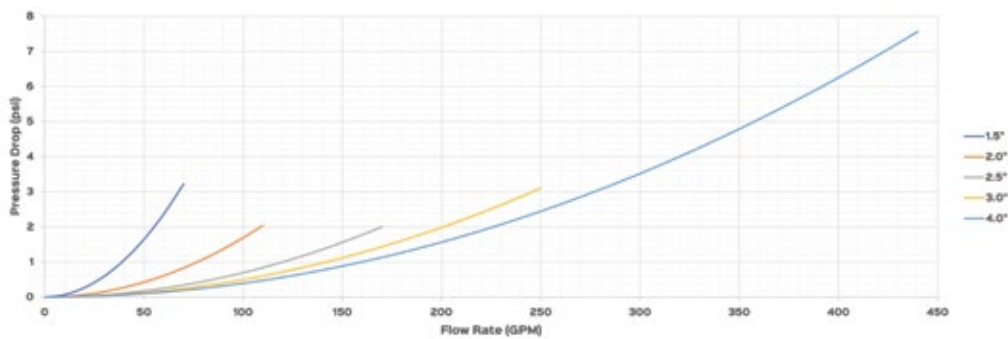

Angle-Line Strainer Pressure Drop: 6.0" Body (High-Capacity), End-Inlet (Standard Flow)

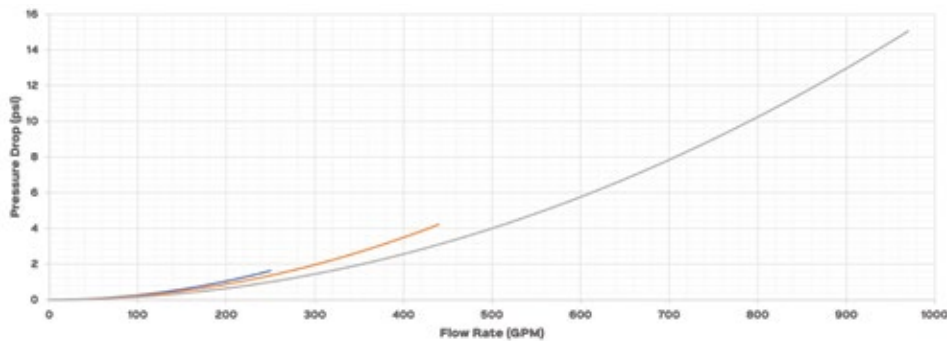

Angle-Line Strainer Pressure Drop: 6.0" Body (High-Capacity), Side-Inlet (Reverse Flow)

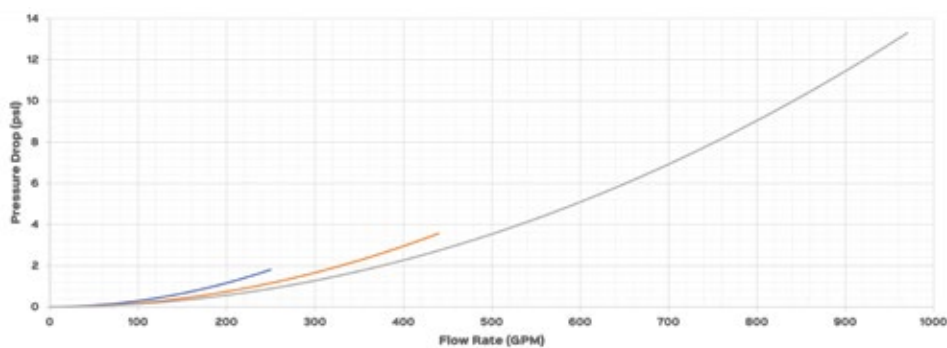

High-Capacity Angle-Line Strainer Model Number Key

Example Model #: HL40T3-P125S56000

		1	2	3	4	5	6	7	8	9	10	11	12	13	14	15	16
1	Strainer Model																
	H	Angle-Line, High-Capacity															
2	Body Length																
	L	LONG Body															
3, 4	Connection Size																
	30	3.0"															
	40	4.0"															
	60	6.0"															
5	Connection Type																
	T	Tri-Clamp (Standard)															
	H	Tri-Clamp - High Pressure Clamp															
	W	Butt Weld*															
6	Finish / Polish																
	3	32 µin Ra / Mechanical Polish (Standard)															
	1	20 µin Ra / Mechanical Polish*															
	8	32 µin Ra / Electropolish*															
	4	15 µin Ra / Electropolish*															
7-10	Element Type / Size																
	P062	Perforated / 0.0625" ($\frac{1}{16}$ ")*															
	P093	Perforated / 0.09375" ($\frac{3}{32}$ ")*															
	P125	Perforated / 0.125" ($\frac{1}{8}$ ")															
	P250	Perforated / 0.25" ($\frac{1}{4}$ ")															
	W001	Wedgewire / 0.001"															
	W002	Wedgewire / 0.002"															
	W005	Wedgewire / 0.005"															
	W007	Wedgewire / 0.007"															
	W010	Wedgewire / 0.010"															
	W015	Wedgewire / 0.015"															
	W020	Wedgewire / 0.020"															
	W030	Wedgewire / 0.030"															
	W040	Wedgewire / 0.040"															
	W060	Wedgewire / 0.060"															
	W187	Wedgewire / 0.1875"															
11	Flow Direction																
	S	End-Inlet (Standard Flow)															
	R	Side-Inlet (Reverse Flow)															
12	Seal Kit																
	5	EPDM Gasket / Teflon Encapsulated Silicone O-Ring (Standard)															
	6	Viton Gasket / Teflon Encapsulated Silicone O-Ring															
	8	Buna-N Gasket / Teflon Encapsulated Silicone O-Ring*															
	9	Silicone Gasket / Teflon Encapsulated Silicone O-Ring*															
	T	Tuf-Flex Gasket / Teflon Encapsulated Silicone O-Ring*															
	0	EPDM Gasket / EPDM O-Ring															
	1	Viton Gasket / Viton O-Ring															
	3	Buna-N Gasket / Buna-N O-Ring*															
13, 14	Body Size																
	60	6.0"															
15	Option #1																
	0	None (Standard)															
	M	Magnetic Trap*															
16	Option #2																
	0	None (Standard)															
	2	Dual Sight Glass*															
	D	Drain / Sample Port*															
	3	Dual Sight Glass & Drain / Sample Port*															

***Non-stock product option. Longer lead times apply. Non-returnable.**

NOTE: See page 34 for element details.

NOTE: Magnetic Trap option is only available with End-Inlet (Standard Flow).

DISTRIBUTED BY

HARCO
ENTERPRISES LTD.
1-800-361-5361

Reference: Former Part Number & New Model Number Comparison

Reference Model Number Key for selections to be made. Selections are designated by empty **green** boxes in the tables below.

High-Capacity Angle-Line End-Inlet (Standard Flow)



Connection Size	Body Size	Max. gpm	LONG (40" Inlet-to-Outlet)	
			Perforated Old Part #	Perforated New Model Key #
4.0"	6"	465	S10176	HL40T3-P <input type="text"/> S <input type="text"/> 60 <input type="text"/>
Connection Size	Body Size	Max. gpm	Wedgewire Old Part #	Wedgewire New Model Key #
4.0"	6"	465	S10175	HL40T3-W <input type="text"/> S <input type="text"/> 60 <input type="text"/>

Recommended Maximum Flows for 3.0" and 6.0" Connection Sizes are 245 gpm and 790 gpm.

High-Capacity Angle-Line Side-Inlet (Reverse Flow)

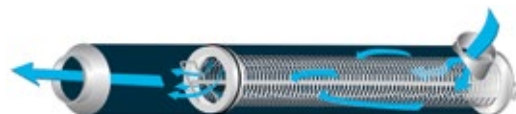

Connection Size	Body Size	Max. gpm	LONG (40" Inlet-to-Outlet)	
			Perforated Old Part #	Perforated New Model Key #
4.0"	6"	510	X10176	HL40T3-P <input type="text"/> R <input type="text"/> 600 <input type="text"/>
Connection Size	Body Size	Max. gpm	Wedgewire Old Part #	Wedgewire New Model Key #
4.0"	6"	510	X10175	HL40T3-W <input type="text"/> R <input type="text"/> 600 <input type="text"/>

Recommended Maximum Flows for 3.0" and 6.0" Connection Sizes are 245 gpm and 840 gpm.

High-Capacity Angle-Line Strainer Options

High-capacity strainers are ideal for higher-volume processes.

The Drain / Sample Port helps operators drain the majority of liquid from the strainers before removing the element for cleaning. Air relief sample valves are recommended for the Drain / Sample Port option.

Strainer sight glasses provide visual access to particulate buildup levels.

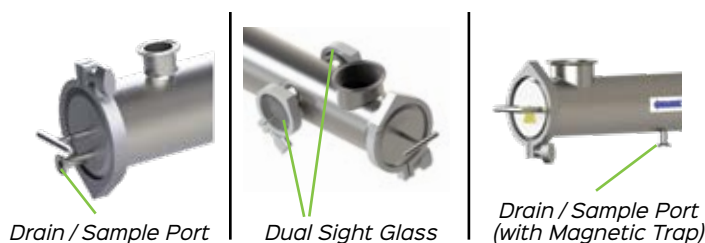

Multi-Angle-Line Strainer Model Number Key

Example Model #: MADV-S15T3-P125S540M2MBPG

		1	2	3	4	5	6	7	8	9	10	11	12	13	14	15	16	17	18	19	20	21	22	23
1, 2	Strainer Model	MA	Multi-Angle-Line																					
3, 4	Configuration Type	DV	Dual Strainers - Vertical																					
5	Body Length	S	SHORT Body																					
	L	LONG Body																						
6, 7	Connection Size	15	1.5"																					
	20	2.0"																						
	25	2.5"																						
	30	3.0"																						
	40	4.0"																						
8	Connection Type	T	Tri-Clamp (Standard)																					
9	Finish / Polish	3	32 µin Ra / Mechanical Polish (Standard)																					
10-13	Element Type / Size	P062	Perforated / 0.0625" (1/16")*																					
	P093	Perforated / 0.09375" (3/32")																						
	P125	Perforated / 0.125" (1/8")																						
	P250	Perforated / 0.25" (1/4")																						
	P375	Perforated / 0.375" (3/8")																						
	W001	Wedgewire / 0.001"																						
	W002	Wedgewire / 0.002"																						
	W005	Wedgewire / 0.005"																						
	W007	Wedgewire / 0.007"																						
	W010	Wedgewire / 0.010"																						
	W015	Wedgewire / 0.015"																						
	W020	Wedgewire / 0.020"																						
	W030	Wedgewire / 0.030"																						
	W040	Wedgewire / 0.040"																						
	W060	Wedgewire / 0.060"																						
	W187	Wedgewire / 0.1875"																						
14	Flow Direction	S	End-Inlet (Standard Flow)																					
	R	Side-Inlet (Reverse Flow)																						
15	Seal Kit	5	EPDM Gasket / Teflon Encapsulated Silicone O-Ring (Standard)																					
	6	Viton Gasket / Teflon Encapsulated Silicone O-Ring																						
	8	Buna-N Gasket / Teflon Encapsulated Silicone O-Ring																						
	9	Silicone Gasket / Teflon Encapsulated Silicone O-Ring																						
	T	Tuf-Flex Gasket / Teflon Encapsulated Silicone O-Ring																						
	0	EPDM Gasket / EPDM O-Ring																						
	1	Viton Gasket / Viton O-Ring																						
	3	Buna-N Gasket / Buna-N O-Ring																						
16, 17	Body Size	40	4.0"																					
18	Option #1	0	None (Standard)																					
	M	Magnetic Trap**																						
19	Option #2	0	None (Standard)																					
	2	Dual Sight Glass*																						
20, 21	Valve Kits	00	None																					
	MB	Manually Operated Butterfly Valves																						
	PB	Pneumatically Operated Butterfly Valves*																						
22, 23	Pressure Kits	00	None																					
	PG	Pressure Gauges																						
	PT	Pressure Transmitters*																						

***Non-stock product option. Longer lead times apply. Non-returnable.** NOTE: See page 34 for element details.

****NOTE:** Magnetic Trap option only available with End-Inlet (Standard Flow) strainers and for 1.5"-3.0" connection sizes.

NOTE: Stand is included in all above configs.

NOTE: Pneumatically Operated Butterfly Valves option requires air supply and automation controls (by others). See page 32 for details.

NOTE: Pressure Transmitters option requires electrical supply and automation controls (by others). See page 32 for details.

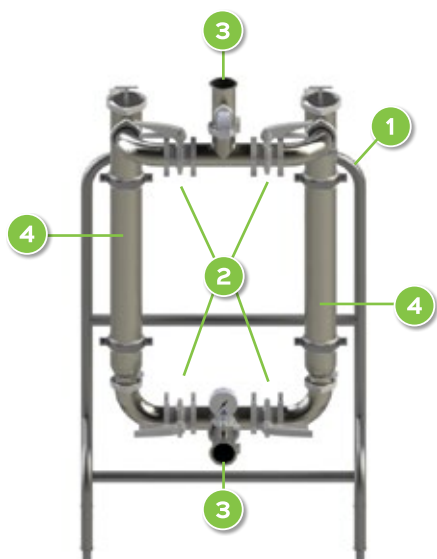

- 1 Dual Vertical Angle-Line Strainer Stand
- 2 Valve Kit
- 3 Pressure Gauge Kit
- 4 Angle-Line Strainers (2)

NOTE: Replacement parts shown on page 32.

Multi-Angle-Line Strainers
Dual Strainers - Vertical
Complete Assembly

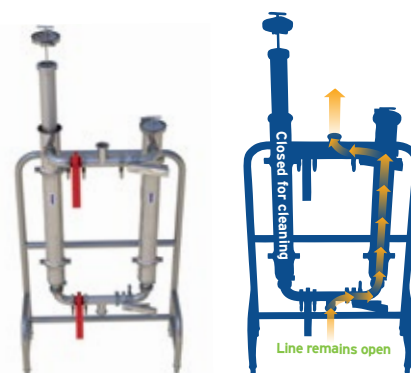

NOTE: The above diagram highlights End-Inlet (Standard Flow) strainers, but Dual Angle-Line Strainer Assemblies can be configured as Side-Inlet (Reverse Flow).

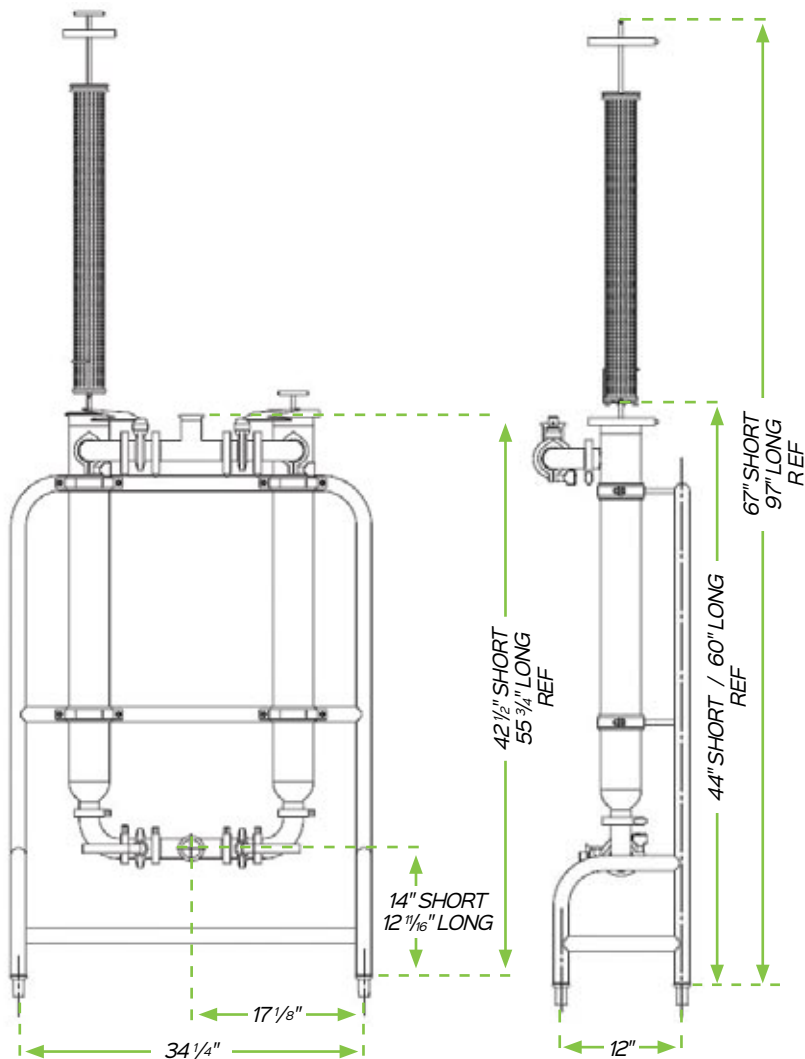

NOTE: Image shown references LONG strainer assemblies. Differences in SHORT and LONG strainer dimensions are noted.



NOTE: Contact Sani-Matic for custom applications such as fully automated assemblies.

Multi-Angle-Line Strainer Replacement Parts

1 Dual Vertical Angle-Line/ALB Strainer Stands

Connection Size	Body Size	SHORT (20 3/4")	LONG (36")
1.5"	4"	254212	257979
2.0"	4"	258021	258010
2.5"	4"	258030	258017
3.0"	4"	258031	257599
4.0"	4"	348193	254256

NOTE: Stands are approximately 35 lbs.



2 Valve Kits

Kit includes: Four (4) Elbows, two (2) Tees, four (4) Butterfly Valves (Manual or Pneumatic), twelve (12) Clamps, and twelve (12) Gaskets.

Material: 316LSS

NOTE: Alternative valves available.

NOTE: Strainers are not included in the valve kit, they are sold separately.

NOTE: Pneumatic Valves have the following requirements:

- 1/8" NPT air fitting ports
- 80 to 100 psi Air Supply Pressure (120 psi Maximum Pressure Rating)
- -4 °F to 250 °F Operating Temperature

Connection Size	Manual Valve Kit Part #	Pneumatic Valve Kit Part #
1.5"	291142	324869
2.0"	291143	324870
2.5"	291144	324871
3.0"	291145	324872
4.0"	291146	324873

3 Pressure Kits

Kit includes: Two (2) Pressure Gauges or Transmitters, two (2) Tees, four (4) Gaskets, and four (4) Clamps.

Connection Size	Pressure Gauge Kit Part #	Pressure Transmitter Kit Part #
1.5"	158581	324874
2.0"	158585	324875
2.5"	158591	324876
3.0"	158593	324877
4.0"	158596	324878

NOTE: Install before and after the strainer assembly.

NOTE: Strainers are not included in the sensor kit, they are sold separately.

NOTE: All Pressure Gauge and Pressure Transmitter options use 1.5" Tri-Clamp connections.

NOTE: Pressure Gauges are Sanitary Diaphragm-type with a 0 to 160 psi range.

NOTE: Pressure Transmitters require a 24V DC power source and output a 4-20mA signal.



Pressure Gauge



Pressure Transmitter

Angle-Line Strainer Replacement Parts

Angle-Line Side-Inlet Strainer (Reverse Flow)

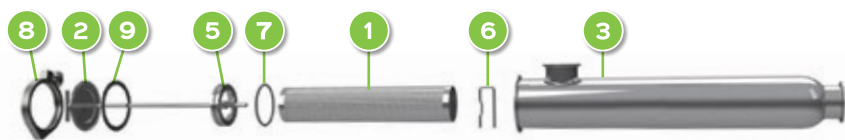

Angle-Line End-Inlet Strainer (Standard Flow)

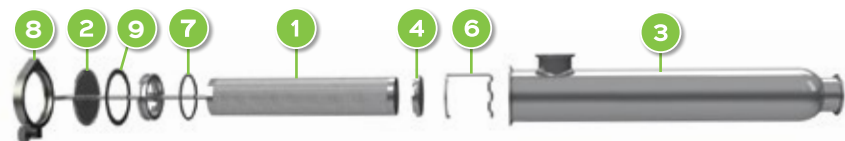

- 1 Strainer Element
- 2 Strainer Element Frame
- 3 Strainer Body
- 4 End Plug
- 5 O-Ring Retainer
- 6 Retaining Clip
- 7 O-Ring
- 8 TC Clamp
- 9 TC Gasket

Spare Parts Kits				
<ul style="list-style-type: none"> 6 Retaining Clip 7 O-Ring 9 TC Gasket 				
Strainer Model	Seal Material	Kit Part # End-Inlet (Standard Flow)	Kit Part # Side-Inlet (Reverse Flow)	
Angle-Line Strainer (4" Body)	EPDM Gasket / Teflon Encapsulated Silicone O-Ring	333551	333560	
Angle-Line Strainer (4" Body)	Viton Gasket / Teflon Encapsulated Silicone O-Ring	333552	333561	
Angle-Line Strainer (4" Body)	Buna-N Gasket / Teflon Encapsulated Silicone O-Ring	333553	333562	
Angle-Line Strainer (4" Body)	Silicone Gasket / Teflon Encapsulated Silicone O-Ring	333554	333563	
Angle-Line Strainer (4" Body)	Tuf-Flex Gasket / Teflon Encapsulated Silicone O-Ring	333555	333564	
Angle-Line Strainer (4" Body)	EPDM Gasket / EPDM O-Ring	333556	333565	
Angle-Line Strainer (4" Body)	Viton Gasket / Viton O-Ring	333558	333566	
Angle-Line Strainer (4" Body)	Buna-N Gasket / Buna-N O-Ring	333559	333567	
Strainer Model	Seal Material	Kit Part # End-Inlet (Standard Flow)	Kit Part # Side-Inlet (Reverse Flow, New Design After 2024)	Kit Part # Side-Inlet (Reverse Flow, Pre-2024 Design)
High-Capacity Angle-Line Strainer (6" Body)	EPDM Gasket / Teflon Encapsulated Silicone O-Ring	333569	333705	333579
High-Capacity Angle-Line Strainer (6" Body)	Viton Gasket / Teflon Encapsulated Silicone O-Ring	333570	333706	333580
High-Capacity Angle-Line Strainer (6" Body)	Buna-N Gasket / Teflon Encapsulated Silicone O-Ring	333571	333707	333581
High-Capacity Angle-Line Strainer (6" Body)	Silicone Gasket / Teflon Encapsulated Silicone O-Ring	333572	333708	333582
High-Capacity Angle-Line Strainer (6" Body)	Tuf-Flex Gasket / Teflon Encapsulated Silicone O-Ring	333573	333709	333583
High-Capacity Angle-Line Strainer (6" Body)	EPDM Gasket / EPDM O-Ring	333574	333710	333584
High-Capacity Angle-Line Strainer (6" Body)	Viton Gasket / Viton O-Ring	333575	333712	333585
High-Capacity Angle-Line Strainer (6" Body)	Buna-N Gasket / Buna-N O-Ring	333576	333713	333586

Flow Direction Conversion Kits

Conversion Kits allow for easy re-configuration of a strainer's flow direction. Order a Spare Parts Kit in addition to a Conversion Kit to complete a re-configuration.

- 2 Strainer Element Frame
- 4 5 End Plug OR O-Ring Retainer

Flow Direction Arrow Sticker

4" Body Angle-Line Strainers

Flow Direction Conversion Kit	Connection Size(s)	SHORT Length Part #	LONG Length Part #
End-Inlet to Side-Inlet	1.5" - 4.0"	346241	346244
Side-Inlet to End-Inlet	1.5" - 3.0"	346242	346245
	4.0"	346243	346246

1 Strainer Elements

Perforated Strainer Elements

Strainer Body Size	Strainer Element Size	Hole Size	Open Area	SHORT (15") Part #	LONG (30") Part #
4"	3"	1/16"	23%	289084	277628
4"	3"	3/32"	33%	721068	720972
4"	3"	1/8"	40%	720584	720585
4"	3"	1/4"	58%	720411	720412
4"	3"	3/8"	51%	720939	720940

Perforated High-Capacity Strainer Elements

6"	4"	1/16"	23%	N/A	289088*
6"	4"	3/32"	33%	N/A	720890*
6"	4"	1/8"	40%	N/A	720799
6"	4"	1/4"	58%	N/A	720800

Wedgewire Strainer Elements

Strainer Body Size	Strainer Element Size	Slot Size	Micron Rating	Wire Mesh (Approx. Equiv.)	Open Area	SHORT (15") Part #	LONG (30") Part #
4"	3"	0.001"	25	500	2.0%	350564*	346237*
4"	3"	0.002"	50	270	4.1%	700323	700334
4"	3"	0.005"	125	120	9.6%	700324	700335
4"	3"	0.007"	177	80	13.0%	700325	700336
4"	3"	0.010"	250	60	17.5%	700326	700337
4"	3"	0.015"	380	40	24.2%	700327	700338
4"	3"	0.020"	500	32	29.9%	700328	700339
4"	3"	0.030"	750	25	39.0%	700329	700340
4"	3"	0.040"	1015	17	46.0%	700330	700341
4"	3"	0.060"	1524	10	56.1%	700331	700342
4"	3"	0.1875"	4775	4	72.5%	700333	700343

Wedgewire High-Capacity Strainer Elements

6"	4"	0.001"	25	500	2.0%	N/A	350309*
6"	4"	0.002"	50	270	4.1%	N/A	700481*
6"	4"	0.005"	125	120	9.6%	N/A	700482
6"	4"	0.007"	177	80	13.0%	N/A	700483*
6"	4"	0.010"	250	60	17.5%	N/A	700484*
6"	4"	0.015"	380	40	24.2%	N/A	700485
6"	4"	0.020"	500	32	29.9%	N/A	700486*
6"	4"	0.030"	750	25	39.0%	N/A	700487
6"	4"	0.040"	1015	17	46.0%	N/A	700488*
6"	4"	0.060"	1524	10	56.1%	N/A	700489
6"	4"	0.1875"	4775	4	72.5%	N/A	700490*

**Non-stock product option. Longer lead times apply. Non-returnable.*

NOTE: Slot size to micron rating is a nominally rated value only.

NOTE: Other perforated and wedgewire sizes are available.

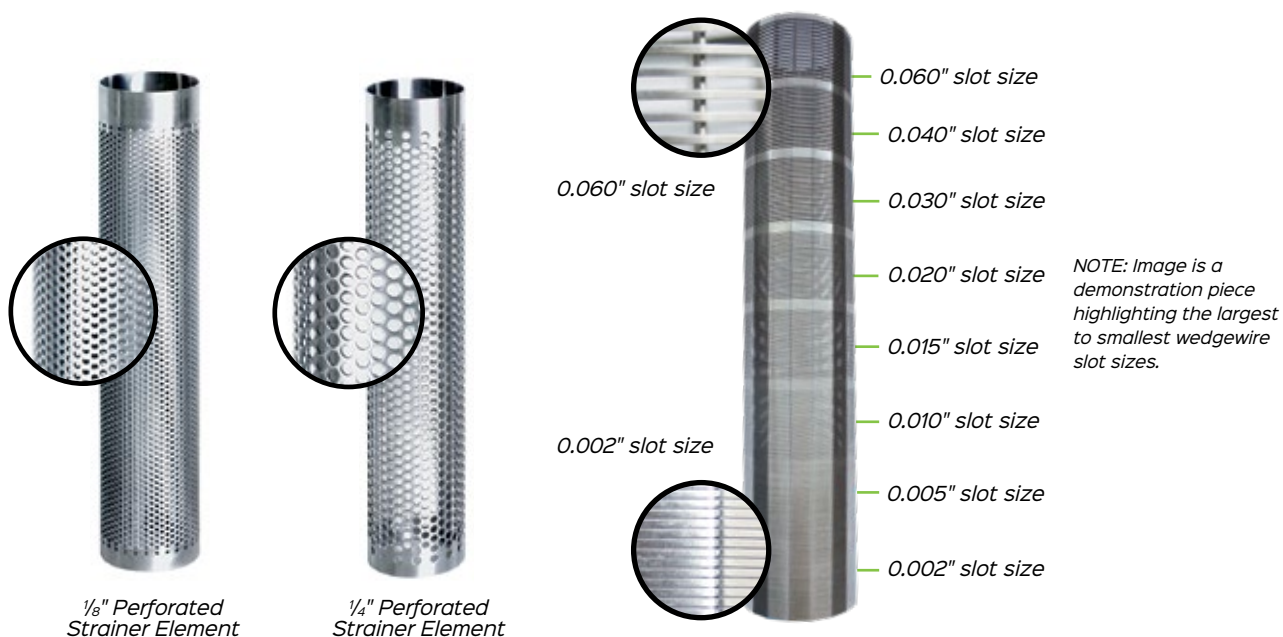

GOOD TO KNOW

- **Element Material:** 316Lss
- **Element Sanitary ID Finish:** 32 μ m Ra
- Wedgewire elements have some interior surfaces greater than 32 μ m Ra due to the construction process.
- End-Inlet Strainers are Standard Flow and Side-Inlet Strainers are Reverse Flow.
- Perforated and wedgewire elements provide different straining advantages:

Advantages of Perforated Elements

- Authorized to carry a 3-A symbol when used without mesh overlay
- Large open area ratio with lower pressure drops
- Can capture fine particulate with wire mesh overlay and filter tubes

Advantages of Wedgewire Elements

- Simple one-piece solution (vs. using mesh overlays or filter tubes with perforated elements)
- Ability to handle higher differential pressures across strainer element

DISTRIBUTED BY

HARCO
ENTERPRISES LTD.
1-800-361-5361



Angle-Line
Side-Inlet
(Reverse Flow)



Angle-Line
Side-Inlet
(Reverse Flow)
- With Drain Port



Angle-Line
End-Inlet
(Standard Flow)



Angle-Line
End-Inlet (Standard Flow)
- With Magnetic Trap

2 Strainer Element Frames

NOTE: End-Inlet Strainers are Standard Flow and Side-Inlet Strainers are Reverse Flow.

Strainer Model	Flow Direction	Strainer Element Length	Strainer Body Length (Inlet-to-Outlet)	Body Size	Strainer Element Frame Length**	Connection Size	Part # (No Drain Port)	Part # (With Drain Port)
Angle-Line	Side-Inlet (Reverse Flow)	SHORT (15")	SHORT (20 3/4")	4.0"	18 1/2"	1.5" - 4.0"	740320	238819
Angle-Line	Side-Inlet (Reverse Flow)	LONG (30")	LONG (36")	4.0"	33 1/2"	1.5" - 4.0"	740348	245133
Angle-Line	End-Inlet (Standard Flow)	SHORT (15")	SHORT (20 3/4")	4.0"	24 5/8"	1.5" - 3.0"	700544	268279
Angle-Line	End-Inlet (Standard Flow)	LONG (30")	LONG (36")	4.0"	40"	1.5" - 3.0"	700546	268276
Angle-Line	End-Inlet (Standard Flow)	SHORT (15")	SHORT (20 3/4")	4.0"	26 5/16"	4.0"	700552	333105*
Angle-Line	End-Inlet (Standard Flow)	LONG (30")	LONG (36")	4.0"	41 11/16"	4.0"	700549	285288*
Angle-Line w/ Magnetic Trap	End-Inlet (Standard Flow)	SHORT (15")	SHORT (20 3/4")	4.0"	24 5/8"	1.5" - 3.0"	288850	N/A
Angle-Line w/ Magnetic Trap	End-Inlet (Standard Flow)	LONG (30")	LONG (36")	4.0"	40"	1.5" - 3.0"	288856	N/A
Strainer Model	Flow Direction	Strainer Element Length	Strainer Body Length (Inlet-to-Outlet)	Body Size	Strainer Element Frame Length**	Connection Size	Part #	Part # (With Drain Port)
High-Capacity Angle-Line (New 2024 Design)	Side-Inlet (Reverse Flow)	LONG (30")	LONG (40")	6.0"	33 11/16"	3.0" - 6.0"	325950	336380*
High-Capacity Angle-Line (Pre-2024 Design)	Side-Inlet (Reverse Flow)	LONG (30")	LONG (40")	6.0"	33 3/4"	3.0" - 6.0"	110123*	294614*
High-Capacity Angle-Line	End-Inlet (Standard Flow)	LONG (30")	LONG (40")	6.0"	43 1/8"	3.0" - 6.0"	740622	284167*
High-Capacity Angle-Line w/ Magnetic Trap	End-Inlet (Standard Flow)	LONG (30")	LONG (40")	6.0"	43 3/16"	3.0" - 6.0"	334222*	N/A

*Non-stock product option. Longer lead times apply. Non-returnable.

**Overall minimum required length for removal clearance.

Angle-Line Side-Inlet Strainer (Reverse Flow)

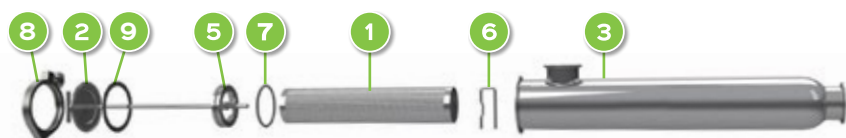

Angle-Line End-Inlet Strainer (Standard Flow)

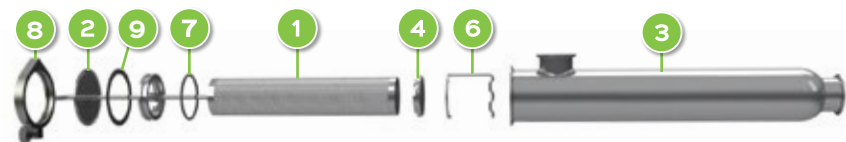

- 1 Strainer Element
- 2 Strainer Element Frame
- 3 Strainer Body
- 4 End Plug
- 5 O-Ring Retainer
- 6 Retaining Clip
- 7 O-Ring
- 8 TC Clamp
- 9 TC Gasket

3 Strainer Bodies (4" Body Size)

Strainer Model	Strainer Body Length (Inlet-to-Outlet)	Tri-Clamp (TC) Connection Size	Part #
Angle-Line	SHORT (20 ³ / ₄ "	1.5"	740835
Angle-Line	SHORT (20 ³ / ₄ "	2.0"	740836
Angle Line	SHORT (20 ³ / ₄ "	2.5"	740837
Angle-Line	SHORT (20 ³ / ₄ "	3.0"	740838
Angle-Line	SHORT (20 ³ / ₄ "	4.0"	741143
Angle-Line	LONG (36"	1.5"	740839
Angle-Line	LONG (36"	2.0"	740840
Angle-Line	LONG (36"	2.5"	740841
Angle-Line	LONG (36"	3.0"	740842
Angle-Line	LONG (36"	4.0"	740986

3 Strainer Bodies (6" Body Size, High-Capacity)

Strainer Model	Strainer Body Length (Inlet-to-Outlet)	Tri-Clamp (TC) Connection Size	Part #
High-Capacity Angle-Line	LONG (40"	3.0"	741244
High-Capacity Angle-Line	LONG (40"	4.0"	741078
High-Capacity Angle-Line	LONG (40"	6.0"	741179

4 End Plugs Use with Angle-Line End-Inlet (Standard Flow) Strainers

Body Size	Material	Part #
4"	316Lss	118582
4"	Teflon	720988
4"	Nylon*	720419
High-Capacity Body Size	Material	Part #
6"	316Lss	118583
6"	UHMW	720616



NOTE: 316Lss end plugs are standard.

*Nylon end plugs cannot be used as part of a 3-A authorized strainer.

5 O-Ring Retainers (Loose) Use with Angle-Line Side-Inlet (Reverse Flow) and Magnetic Trap Strainers

Body Size	Part #
4"	721488
High-Capacity Body Size	Part #
6" (New Design)	325471
6" (Pre-2024 Design)	226783*

NOTE: End-Inlet O-Ring Retainers are welded to the Strainer Element Frame.

O-Ring Retainer 226783 is not compatible with Magnetic Trap Strainers.

*Non-stock product option. Longer lead times apply. Non-returnable.



4" and 6" (New Design)
O-Ring Retainer



6" O-Ring Retainer
(Pre-2024 Design)

6 Retaining Clips Use with all Angle-Line Strainers

Body Size	Flow Direction	Part #
4"	Side-Inlet (Reverse Flow)	720408
4"	End-Inlet (Standard Flow)	740295
High-Capacity Body Size	Flow Direction	Part #
6"	Side-Inlet (Reverse Flow) - (New Design)	330468
6"	Side-Inlet (Reverse Flow) - (Pre-2024 Design)	320033
6"	End-Inlet (Standard Flow)	740623



4" Side Inlet Clip
6" Side Inlet Clip (New Design)
(Reverse Flow)



6" Side Inlet Clip (Pre-2024 Design)
(Reverse Flow)



4" and 6" End-Inlet Clip
(Standard Flow)

High-Capacity Angle-Line Side-Inlet (Reverse Flow) Strainer Retainer Upgrade Kit	
<div> <div>2</div> Strainer Element Frame <div>5</div> O-Ring Retainer <div>6</div> Retaining Clip </div>	
Strainer Model	Upgrade Kit Part #
High-Capacity (6" Body) Angle-Line Strainer Retainer Upgrade Kit, Side-Inlet (Reverse Flow)	333714

NOTE: This upgrade kit includes the latest design strainer element frame, O-Ring retainer, and retaining clip to use with reverse flow high-capacity angle-line strainers. The design provides an upgraded sealing design.

7 O-Rings Use with all Angle-Line Strainers

Body Size	Material	Part #
4"	EPDM	020503
4"	Viton	020236
4"	Teflon Encapsulated Silicone	024020
4"	Buna-N	020234
High-Capacity Body Size	Material	Part #
6"	EPDM	022416
6"	Viton	036747
6"	Teflon Encapsulated Silicone	034355
6"	Buna-N	020222

NOTE: Teflon Encapsulated Silicone is O-Ring standard. Other materials require lubrication.

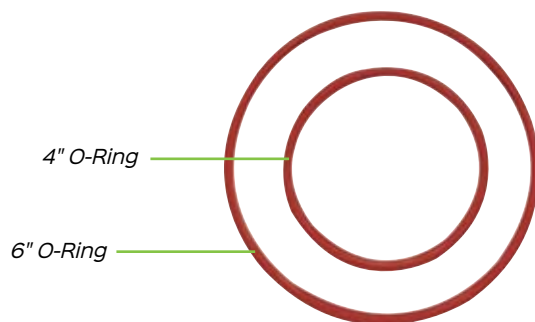

4" O-Ring

6" O-Ring

8 Tri-Clamp (TC) Clamps

Clamp Type	Part #			
	0.50" / 0.75"	2.5"	8 4.0"	8 6.0"
	For Sample Valve / TC Cap	For Sight Glass	For Strainer Body	For High-Capacity Strainer Body
Standard	020224	020083	020225	020976
High Pressure	022235	020914	020916	025686



Standard Clamp



High Pressure Clamp

Tri-Clamp (TC) Gaskets

Material	Part #				
	0.50"	0.75"	2.5"	9 4.0"	9 6.0"
	For TC Cap	For Sample Valve	For Sight Glass	For Strainer Body	For High-Capacity Strainer Body
EPDM (Standard)	021036	021037	021029	021031	022975
Viton	028724	028725	028729	020474	023847
Silicone	022352	022353	023184*	024582	025683*
Buna-N	031690*	020230*	020091	020226	020263*
Tuf-Flex	046732	046733	046737	046739	046740*



*Non-stock product option. Longer lead times apply. Non-returnable.

Sight Glass Replacements



Description	Part #
VL-3A Sight Glass Assembly, 2.5" TC	056231

NOTE: VL-3A Sight Glass Assemblies come with the sight glass lens, sight glass ferrule, and sight glass gasket.

Sample Valve



Description	Part #
Sample Valve, TC, 0.50"/0.75" Process Connection, 0.5" Sample Connection	060887

NOTE: Air relief sample valves are recommended for the Drain / Sample Port option.

Tri-Clamp (TC) Caps

TC Caps can be used on Drain / Sample Port to cap the port.

Description	Part #
TC Cap, 0.50" / 0.75", 316Lss	020529



ID Tag

Custom tag your components with an engraved stainless steel tag, affixed to the component using ball chain. Up to 10 characters can be specified.

Description	Part #
ID Tag, 2.0" x 0.5", 304ss	720826



Angle-Line Strainer Accessories

Mesh Overlays (For perforated elements only) 316ss Wire

Mesh Size US	Body Size	Micron (Approx. Equiv.)	Opening Width in Inches (Approx. Equivalent)	Open Area	Part # (14.63" OAL) SHORT Body	Part # (29.63" OAL) LONG Body
8	4.0"	2360	0.0970"	60%	035251	029664
10	4.0"	2000	0.0750"	56%	000717	000701
12	4.0"	1700	0.0603"	52%	035252	029665
20	4.0"	850	0.0340"	46%	000712	000702
30	4.0"	600	0.0213"	41%	000713	000703
40	4.0"	425	0.0150"	36%	000714	000704
50	4.0"	300	0.0110"	30%	000715	000705
60	4.0"	250	0.0092"	31%	000716	000706
80	4.0"	180	0.0070"	31%	000718	000708
100	4.0"	150	0.0060"	36%	000711	000710
120	4.0"	125	0.0046"	31%	000720	000707
150	4.0"	98	0.0041"	37%	021276	021274
200	4.0"	75	0.0029"	34%	021275	10000048
High-Capacity Mesh Overlays						
20	6.0"	850	0.0340"	46%	N/A	037929*
40	6.0"	425	0.0150"	36%	N/A	048637*
50	6.0"	300	0.0110"	30%	N/A	055640*
60	6.0"	250	0.0092"	31%	N/A	044369*
80	6.0"	180	0.0070"	31%	N/A	044368*
100	6.0"	150	0.0060"	36%	N/A	038981*
120	6.0"	125	0.0046"	31%	N/A	035514*
150	6.0"	100	0.0041"	37%	N/A	000719

*Non-stock product option. Longer lead times apply. Non-returnable. Minimum order quantity of (2) units.

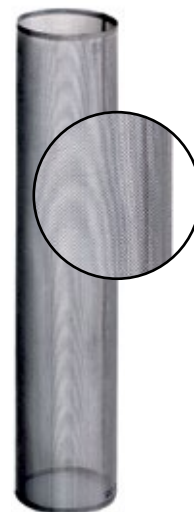

Mesh Overlay

Filter Tube: 4" Body Size x 20 1/2" Body Length Strainers • 50/Box

4 7/8" x 17" Filter Tubes (For 1.5", 2", 2.5", 3", and 4" connections). Fits 3" x 15" Perforated Element.

Material	Width	Length (SHORT)	Max. Temperature (°F)	Micron	Part #
Polyester	4 7/8"	17"	400	25	032789
Polyester	4 7/8"	17"	400	40	048602
Polyester Multifilament	4 7/8"	17"	270 continuous, 455 short term	80	041235
Nylon Multifilament	4 7/8"	17"	185 continuous, 455 short term	150	031264
Polyester Knit	4 7/8"	17"	270 continuous, 455 short term	225	033922
Polyester Monofilament	4 7/8"	17"	270 continuous, 455 short term	250	036985
Plain Weave Cotton Cloth	4 7/8"	17"	300	270	028476
Nylon Monofilament	4 7/8"	17"	270 continuous, 455 short term	400	048603
Nylon Monofilament	4 7/8"	17"	185 continuous, 455 short term	800	031133
Nylon Multifilament	4 7/8"	17"	185 continuous, 455 short term	1000	028335

Filter Tube: 4" Body Size x 40" Body Length Strainers • 50/Box

4 7/8" x 33 1/2" Filter Tubes (For 1.5", 2", 2.5", 3", and 4" connections). Fits 3" x 30" Perforated Element.

Material	Width	Length (LONG)	Max. Temperature (°F)	Micron	Part #
Non-Woven Polyester	4 7/8"	33 1/2"	400	25	028390
Polyester	4 7/8"	33 1/2"	400	40	028857
Polyester Multifilament	4 7/8"	33 1/2"	270 continuous, 455 short term	80	029075
Nylon Multifilament	4 7/8"	33 1/2"	185 continuous, 455 short term	150	028395
Polyester Monofilament	4 7/8"	33 1/2"	270 continuous, 455 short term	225	040565
Polyester Monofilament	4 7/8"	33 1/2"	270 continuous, 455 short term	250	030951
Plain Weave Cotton Cloth	4 7/8"	33 1/2"	300	270	028797
Polyester Multifilament	4 7/8"	33 1/2"	270 continuous, 455 short term	400	023864
Cotton Flannel	4 7/8"	33 1/2"	300	500	029190
Nylon Monofilament	4 7/8"	33 1/2"	275	500	041618
Nylon Multifilament	4 7/8"	33 1/2"	185 continuous, 455 short term	800	10000044

Magnetic Trap Strainers

The Sani-Matic Angle-Line Magnetic Trap Strainer doubles as a strainer and magnetic trap to ensure product integrity and equipment protection against metal particles, such as iron, 304 stainless steel, and shed metal-detectable gaskets, while also straining process particles such as seeds, pulp, and more. The magnetic trap's location within the strainer body eliminates the need for a second process line cut.

Current Standard Flow, Angle-Line Strainer bodies can easily become a Magnetic Trap Strainer by adding a Magnetic Trap Element Frame and the corresponding angle-line element retaining parts.

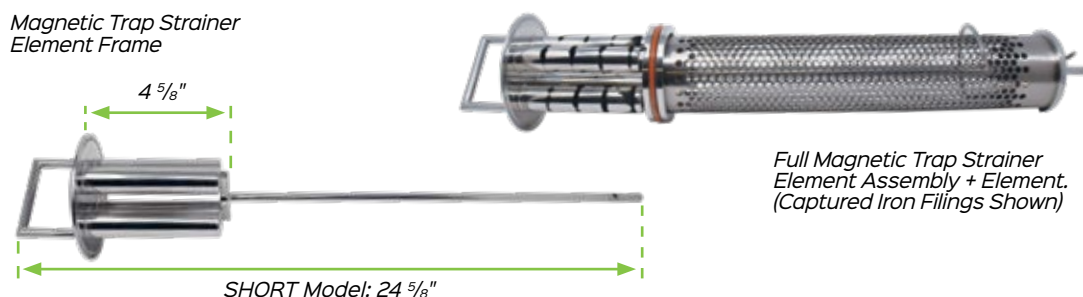

QUICK TIPS

Oh my Gauss! How strong is that magnet? Magnet flux density, or intensity, is measured in Gauss. It can be measured via Pull Tests and Gauss Meters. A pull test shows the pull force of a magnet by the amount of force required to break free of the magnet.

Strong but not unbreakable. While the magnets maintain a strong hold, they are not unbreakable. If not handled with care, the strainer element frame's magnets can shatter and lose efficacy.

Are there safety considerations? The magnets have a powerful pull. Working with metal tools next to the magnetic trap may pinch hands, and the magnets may be harmful to ID wearers and people with pacemakers.

GOOD TO KNOW

- **Magnetic Rating Range:** 9,500 - 11,500 Gauss
- **Maximum Temperature:** 220 °F (custom high temperature versions are available)
- **Finish:** 32 µin Ra
- **Magnet:** Neodymium rare-earth element
- Standard Flow Only
- Is not authorized to carry a 3-A symbol
- Gauss certificate is provided
- Magnetic Trap captures magnetic items; the Element captures the other product debris (pulp, seeds, etc.)
- Adding magnetic trap capabilities adds minimal pressure drop (approx. 5% increase)
- Sani-Matic provides a recertification service where old units can be sent in for testing to ensure magnetic strength is sufficient, or if replacement is needed

Metal Fines Capture Efficacy Conditions

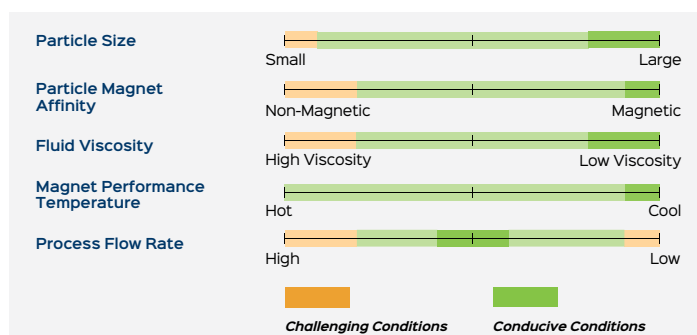

See the Magnetic Strainer Capture 304ss Particles

Magnetic Trap Strainer Frame Assemblies

Includes Frame, O-Ring Retainer, End Plug, and Retaining Clip

Strainer Model	Flow Direction	Strainer Element Length	Strainer Body Length (Inlet-to-Outlet)	Body Size	Strainer Element Frame Length	Connection Size	Part #
Angle-Line w/ Magnetic Trap	End-Inlet (Standard Flow)	SHORT (15")	SHORT (20 3/4")	4"	24 5/8"	1.5" - 3.0"	334219
Angle-Line w/ Magnetic Trap	End-Inlet (Standard Flow)	LONG (30")	LONG (36")	4"	40"	1.5" - 3.0"	334220



Watch how to easily retrofit the Magnetic Trap Strainer!

Replacement Parts

1 Magnetic Trap Strainer Frames

Strainer Model	Flow Direction	Strainer Element Length	Strainer Body Length (Inlet-to-Outlet)	Body Size	Strainer Element Frame Length**	Connection Size	Part #
Angle-Line w/ Magnetic Trap	End-Inlet (Standard Flow)	SHORT (15")	SHORT (20 3/4")	4.0"	24 5/8"	1.5" - 3.0"	288850
Angle-Line w/ Magnetic Trap	End-Inlet (Standard Flow)	LONG (30")	LONG (36")	4.0"	40"	1.5" - 3.0"	288856
High-Capacity Angle-Line w/ Magnetic Trap	End-Inlet (Standard Flow)	LONG (30")	LONG (40")	6.0"	43 3/16"	3.0" - 6.0"	334222*

*Non-stock product option. Longer lead times apply. Non-returnable.

**Overall allowable length for removal clearance.

2 Magnetic Trap Strainer O-Ring Retainer

Body Size	Flow Direction	Part #
4"	End-Inlet (Standard Flow)	721488
6"	End-Inlet (Standard Flow) (New Design)	325471

3 Retaining Clips

Body Size	Flow Direction	Part #
4"	End-Inlet (Standard Flow)	740295
6"	End-Inlet (Standard Flow)	740623

4 End Plug

Body Size	Material	Part #
4"	316Lss	118582
6"	316Lss	118583

Services (Magnetic Trap)

Magnetic traps can be sent into Sani-Matic for re-verification of pull strength & Gauss measurements.

Description	Part #
Magnetic Trap Recertification	MAGNETIC TRAP RECERTIFICATION